

REAR SEAT BELT REMOVAL/INSTALLATION

B3E081157630W04

Caution

- The ELR (emergency locking retractor) has a spring that will unwind if the retractor cover is removed. The spring cannot be rewound by hand. If this occurs, the ELR will not work properly. Therefore, do not disassemble the retractor.

4SD

1. Remove the following parts:

- (1) Rear seat (See [REAR SEAT REMOVAL/INSTALLATION.](#))
- (2) Rear scuff plate (See [REAR SCUFF PLATE REMOVAL/INSTALLATION.](#))
- (3) Tire house trim (See [TIRE HOUSE TRIM REMOVAL/INSTALLATION.](#))
- (4) C-pillar trim (See [C-PILLAR TRIM REMOVAL/INSTALLATION.](#))
- (5) Rear package trim (See [REAR PACKAGE TRIM REMOVAL/INSTALLATION.](#))

2. Remove in the order indicated in the table.

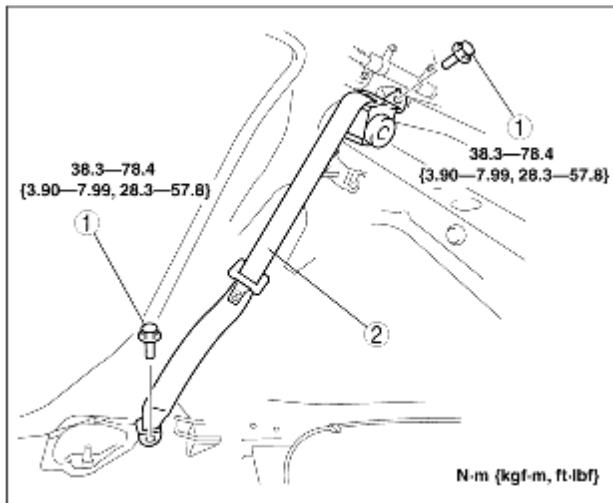

1	Bolt
2	Rear seat belt

3. Install in the reverse order of removal.

5HB

1. Remove the following parts:

- (1) Rear seat (See [REAR SEAT REMOVAL/INSTALLATION.](#))
- (2) Rear scuff plate (See [REAR SCUFF PLATE REMOVAL/INSTALLATION.](#))
- (3) Tire house trim (See [TIRE HOUSE TRIM REMOVAL/INSTALLATION.](#))
- (4) Trunk side upper trim (See [TRUNK SIDE UPPER TRIM REMOVAL/INSTALLATION.](#))
- (5) C-pillar trim (See [C-PILLAR TRIM REMOVAL/INSTALLATION.](#))

2. Remove in the order indicated in the table.

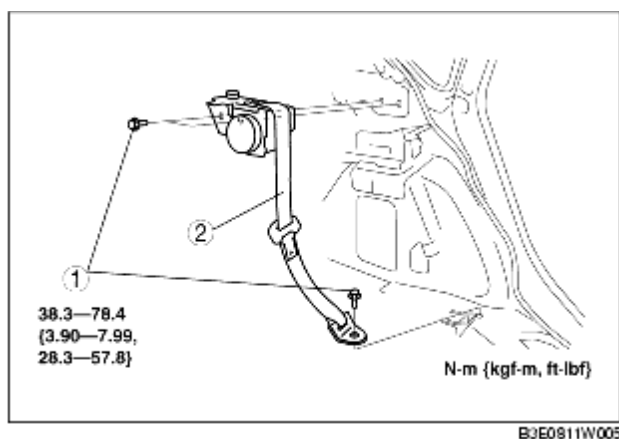

1	Bolt
2	Rear seat belt

3. Install in the reverse order of removal.